

1/4" DRIVE SOCKETS & ATTACHMENTS

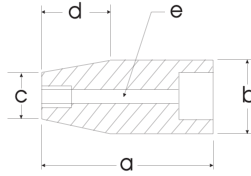

6 Point Standard Length

Hex Size	6 Point Part No.	Overall Length mm a	Drive End mm b	Hex End mm c	Taper Length mm d	Bolt Clearance mm e
4mm	M604	22.25	11.33	6.96	11.07	3.73
4.5mm	M604.5	22.25	11.33	6.96	11.07	3.73
5mm	M605	22.25	11.33	7.85	11.07	4.11
5.5mm	M605.5	22.25	11.33	7.85	11.07	4.11
6mm	M606	22.25	11.33	9.25	11.07	4.90
7mm	M607	22.25	11.33	10.74	11.07	5.49
8mm	M608	22.25	11.76	11.76	—	5.28
9mm	M609	22.25	12.75	12.75	—	5.28
10mm	M610	22.25	13.87	13.87	—	10.16
11mm	M611	22.25	15.57	15.57	—	11.15
12mm	M612	22.25	17.12	17.12	—	12.17
13mm	M613	22.25	18.39	18.39	—	13.18
14mm	M614	22.25	19.81	19.81	—	14.20
15mm	M615	22.25	19.81	19.81	—	14.20

Federal Spec. CDA 39-GP-12M U.S. GGG-W-641E ANSI B1075

6 Point Deep Length

Hex Size	6 Point Part No.	Overall Length mm a	Drive End mm b	Hex End mm c	Taper Length mm d	Bolt Clearance mm e
4mm	ML604	50.80	11.43	6.96	22.35	5.33
5mm	ML605	50.80	11.35	8.03	22.61	5.33
5.5mm	ML605.5	50.80	11.33	8.83	22.61	5.33
6mm	ML606	50.80	11.33	9.37	22.61	6.10
7mm	ML607	50.80	11.33	10.74	22.61	6.10
8mm	ML608	50.80	11.33	11.33	—	6.10
9mm	ML609	50.80	12.57	12.57	—	6.48
10mm	ML610	50.80	13.82	13.82	—	6.10
11mm	ML611	50.80	15.57	15.57	—	6.10
12mm	ML612	50.80	17.12	17.12	—	6.10
13mm	ML613	50.80	18.39	18.39	—	6.10
14mm	ML614	50.80	19.63	19.63	—	6.10

Federal Spec. CDA 39-GP-12M U.S. GGG-W-641E ANSI B1075

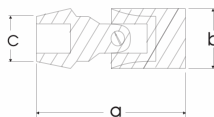

12 Point Universal Joint Sockets Standard Length

Hex Size	12 Point Part No.	Overall Length in. a	Drive End in. b	Hex End in. c
3/16"	VU6	1.38	0.30	0.55
7/32"	VU7	1.38	0.33	0.55
1/4"	VU8	1.38	0.36	0.55
9/32"	VU9	1.45	0.41	0.55
5/16"	VU10	1.45	0.47	0.55
11/32"	VU11	1.45	0.51	0.55
3/8"	VU12	1.56	0.55	0.55
7/16"	VU14	1.56	0.61	0.55
1/2"	VU16	1.56	0.70	0.55
9/16"	VU18	1.56	0.74	0.55

6 Point Universal Joint Sockets Standard Length

Hex Size	6 Point Part No.	Overall Length mm a	Drive End mm b	Hex End mm c
5mm	MU5H	35	6	9.5
6mm	MU6H	35	6	9.5
7mm	MU7H	35	8	9.5
8mm	MU8H	35	8	9.5
9mm	MU9H	35	8	9.5
10mm	MU10H	40	8.5	9.5
11mm	MU11H	40	8.5	9.5
12mm	MU12H	40	8.5	9.5
13mm	MU13H	40	8.5	9.5

Note: NOT FOR IMPACT USE.

Above items on this page are for hand use only.